



HAND CRAFTED BY AUSTRALIA'S MOST AWARDED LUXURY MOTOR YACHT BUILDER

ALWAYS BE OPEN TO NEW ADVENTURES

The Riviera 43 Open Flybridge



43 OPEN FLYBRIDGE

Edition 23.1

FIRST CLASS ALL THE WAY

In business, the view from the top has many perspectives — uplifting, time-constraining, always challenging. Come on, you've earned a break. Another view from the top awaits. And it is calling you now. This is a world filled only with happiness and success — family and friends, luxury and renewal, unforgettable memories and joy.

At the helm of your magnificent new Riviera Flybridge luxury motor yacht, you oversee a world of unsurpassed beauty and grace, where life glistens and shines. The yachts from the Riviera Flybridge Collection, the 39, 43 and 54 can effortlessly fly you and your loved ones here.

You will be traveling in sublime blue water style. With world-renowned craftsmanship and quality, space, light, luxury, breathtaking accommodation and thoughtful inclusions at every turn. All underpinned by superior strength and build, astonishing stability and spirited performance.

Welcome aboard the world-renowned Riviera Flybridge Collection. What a way to fly.

RIVIERA FLYBRIDGE COLLECTION

39 • 43 • 54



Rodney Longhurst
Owner, Riviera





REFRESHINGLY DIFFERENT REASSURINGLY RIVIERA



Though descended from motor yachts designed to fish for a living, and evolving into yachts to fish for fun, the modern flybridge yacht has come to serve many purposes. And like us all, needs to meet many demands. Because Riviera thoroughly researches and carefully listens to the way owners use their yachts, we're always refining our concepts and designs.

Today, those demands and wishes centre upon more family interaction, meaningful time with friends and the sensible siren song of the work-life balance. Hence, the 43 Open Flybridge from Riviera is a multi-tasking vessel that will help you fully enjoy the luxury life afloat.

THE SAME, BUT VERY DIFFERENT

The 43 Open Flybridge is designed for both serious fishing and for serious fun. The unencumbered styling conceals a host of smart features that serve to make life in the 43's cockpit as practical and enjoyable as possible. This is, indeed, a spacious and enjoyable playground for you and your friends, with volumes of storage to keep everything you need right at hand when required.

Fishing enthusiasts will be pleased to know the floor is reinforced with an alloy plate for a game chair. In addition, a live bait tank can be built into the transom.

For the alfresco chef, an optional gourmet barbecue centre with interchangeable grill and sizzling plates can also be located aft, incorporating a sink, rubbish bin and storage for cooking utensils.

As you can see, the 43 Open has been skillfully designed for versatility — just the way our global family of Riviera owners like it.









SAFELY FORWARD

Wide side decks, high stainless steel side rails as well as convenient hand rails provide safe and confident passage to the forward deck for your crew, children and pets.

The anchoring equipment is stored neatly in her bow lockers — conveniently out of sight but right there when you need it.

Here is a space for serious sunning or perhaps quiet contemplation, with an optional lavish sun pad to enhance your sense of space and freedom.

If you require, an optional davit can be placed on the forward deck to assist with lifting and storing your tender.

DINING DELIGHTS

Instead of dividing the space into a number of small, less-connected areas, we've brought them all together into a unified, flowing, single-level lifestyle space that runs unimpeded from swim platform to windscreen. This makes enormous sense. Today's luxury motor yacht usage isn't the least bit compartmentalised. You don't: prepare a meal and all go to the galley; eat a meal and all sit together in the dinette; TV time, all go to the lounge area; nor come fishing or barbeque time, all head out to the cockpit. In the real world, many (or all) of these activities can happen simultaneously, often in the glorious company of many guests.

PRACTICAL AND PURPOSEFUL

If there's one question that characterises Riviera it is — "How can we make your boating easier and more enjoyable?" The answer is richly expressed in the 43 Open Flybridge saloon, where you'll feel right at home. Large, forward and side-opening windows capture natural light and fresh air and an aft awning window, set in a strong, stainless steel frame, opens out to the cockpit. The free-flowing feel from the saloon through to the swim platform is evident as you relax in the large, superbly-upholstered U-shaped lounge. Or entertain your family and friends for dinner around the saloon table, which can be converted into a coffee table or optionally, an additional berth.

Overhead, the saloon headlining is padded and finished in leatherette, and a highly-polished stainless, elliptical handrail is recessed and runs through the centre for added passenger stability. The 43's LED TV folds up from the starboard-side dash — conveniently keeping it out of the way when not in use but ensuring easy access when required. The TV is integrated with an entertainment system featuring iPod interface and subwoofer, also cleverly stored out of sight.









STATE OF LUXURY STATEROOMS

The 43 Open's master stateroom is located forward and a luxurious space to rest and revitalise. There are numerous and pleasing 'little touches' such as the deep plush carpet, mirrors, reflective mood lighting and the positive-locking hardware on the cabinetry.

The queen-sized bed has a premium innerspring mattress that will assist your slumber, and underneath we have designed generous storage to keep the room clean, uncluttered and comfortable.

As you might expect, the 43 Open's master ensuite also features our premium styling. It is this relentless obsession detail, quality, and good design that drives Riviera to make your boating experience the absolute best it possibly can be.

SPOIL YOUR GUESTS

The 43 Open Flybridge's versatility extends to the full-beam guest stateroom aft, which can sleep up to three adults in absolute comfort.

Full-sized single beds with storage under can slide across to form a queen-sized, island bed if preferred. And there's an additional single bed to starboard. Fresh air fills the stateroom through opening portholes with alarms that will sound if left open when the ignition is engaged.

The premium-finish can be easily seen throughout the accommodation deck that also includes the VIP guest ensuite which doubles as the dayhead. A clever two-way door creates privacy for guests who will be impressed by the consistency of Riviera's attention to detail, and luxurious appointments throughout. An additional overhead deck hatch, also with block-out screen, has a dual-purpose of allowing extra fresh air and light.









A FLYBRIDGE TO LOOK UP TO

The Riviera 43 Open Flybridge incorporates great function and style within a supremely comfortable, sea-kindly hull. Her expansive open flybridge space is accessible from the cockpit via the Riviera designed 'stair-ladder' which features teak treads for the safety of you and your crew.

Forward of the helm station is a wrap-around lounge and table where you can relax while enjoying a healthy and hearty breakfast, or raise a toast to life as the sun slowly sets. If you prefer to simply admire the sweeping 360-degree vision whilst listening to your own personal soundtrack, the Riviera 43's flybridge also sports a superb entertainment system.

PLEASE, TAKE COMMAND

A raft of proven, ultramodern technology makes the 43 Open Flybridge incredibly easy to skipper. The benefits of Volvo Penta's Inboard Propulsion System (IPS) extend to joystick manoeuvrability, which enables a skipper — either solo or with a novice crew — to simply push and twist the joystick and make the yacht respond immediately, pivoting in place or tracking sideways into a berth.

The aft helm is ergonomically designed, with two premium helm chairs ensuring the comfort of both the skipper and their companion whilst underway.









ENGINEERING EXCELLENCE

The clean and uncluttered engine room — with acoustic and thermal insulation and LED lighting — highlights the skilled consideration for which Riviera is highly-regarded globally in terms of engineering.

The impressive, commercial air-intake system helps keep the engine room temperature well below the manufacturer's formal recommendation, reducing fuel consumption even further, while the air conditioning units feed condensation water into the common drain lines located on either side of the yacht. Two automatic bilge pumps with manual override are located at various points throughout the hull.

There's even a dedicated space for a gyroscopic stabiliser on the centreline of the yacht — yet another example of how Riviera is embracing all innovations to make boating more enjoyable.



ELECTRICAL EXCELLENCE

All batteries on board the 43 Open Flybridge are maintenance-free — to ensure carefree boating — and housed in special battery boxes in accordance with the American Boating & Yacht Council (ABYC) and European Union's CE industry standards.

The house power is 24-volt which allows for simpler charging, lower current draw and smaller cables (further reduced weight) than equivalent 12-volt systems. The inverter provides power to the icemaker and entertainment systems, ensuring whisper-quiet relaxation at anchor.

LED lighting is featured throughout the yacht reducing electrical current draw. Additionally, Residual Circuit Interrupter (RCD/GFCI) provides protection over the entire yacht and also complies with ABYC and CE standards for safer boating.

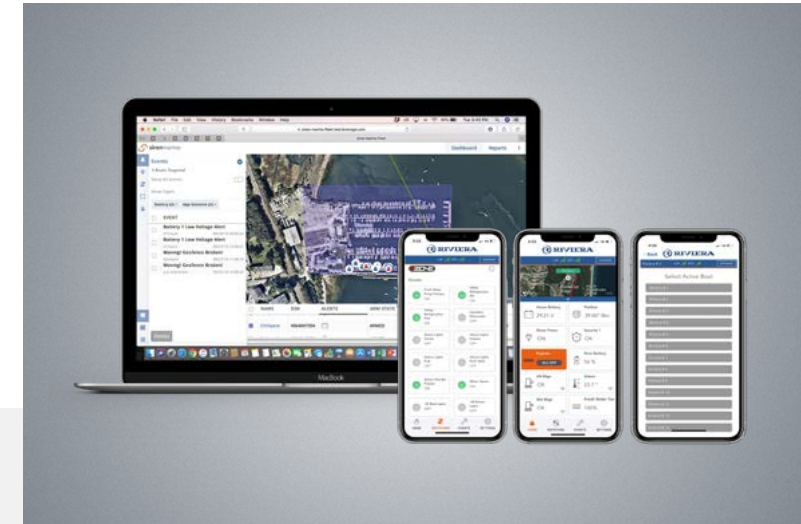



43 OPEN FLYBRIDGE SPECIFICATIONS

Length Overall (inc. swim platform and bow sprit)	14.56 m	47' 9"	Sleeping Capacity	6 persons	
Hull Length (Lh to ISO8666) *	13.61 m	44' 8"	Cockpit Area	7.20 m ²	77.50 ft ²
Beam (inc. gunwale)	4.57 m	15' 0"	Bridge Clearance	6.10 m	20'
Maximum Draft (inc. props)	1.20 m	3' 11"	Standard Engine	Volvo Penta D6 IPS 600 x 2	
Dry Weight ** (approx. depends on options)	14,982 kg	33,030 lb		324 kW	440 hp each
Fuel Capacity ***	2,000 L	528 US gal	*Specifications may vary on a regional basis.		
Water Capacity ***	460 L	122 US gal			
Holding Tank Capacity ***	151 L	40 US gal			

CLARIFICATION AND OUR CARE FOR YOUR INFORMATION

* Length of the hull (Lh) to ISO8666: includes all structural and integral parts (i.e. the moulded length of the hull). It excludes parts that can be removed in a non-destructive manner without affecting the structural integrity of the craft (e.g. pulpits, outdrives, driving platforms, rubbing strakes).

** Dry weight represents the estimated minimum weight of a yacht with standard engines and options, no fuel or water on board, no equipment or provisions and no personnel. The stated dry weight may be exceeded.

*** Denotes net tank capacity. For useable capacity do not rely on more than 90% of tank capacity. Actual capacity will vary according to yacht trim and sea state. Speeds are subject to normal weather conditions, fuel and/or water levels, passengers and equipment loads.

Due to the constant refinement of specifications and design by Riviera Australia, the information in this document may change without notice. Specifications may vary with time and by region. Some images or illustrations in this brochure may include options or custom details. Please note that as safety equipment specifications or standards vary by country, this aspect of your purchase will need to be completed by you and/or your Riviera representative. Please refer to your Riviera representative for specific warranty cover and the latest detailed list of inclusions and options prior to purchase.



HARDTOP



FLYBRIDGE DECK

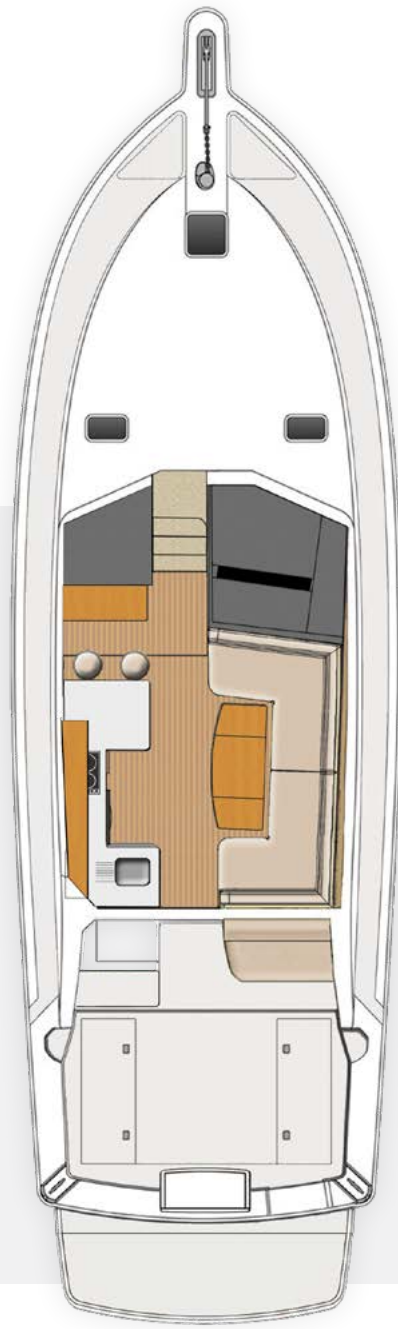

SALOON DECK
Shown with optional cockpit barbecue



SALOON DECK
Shown with optional lower helm

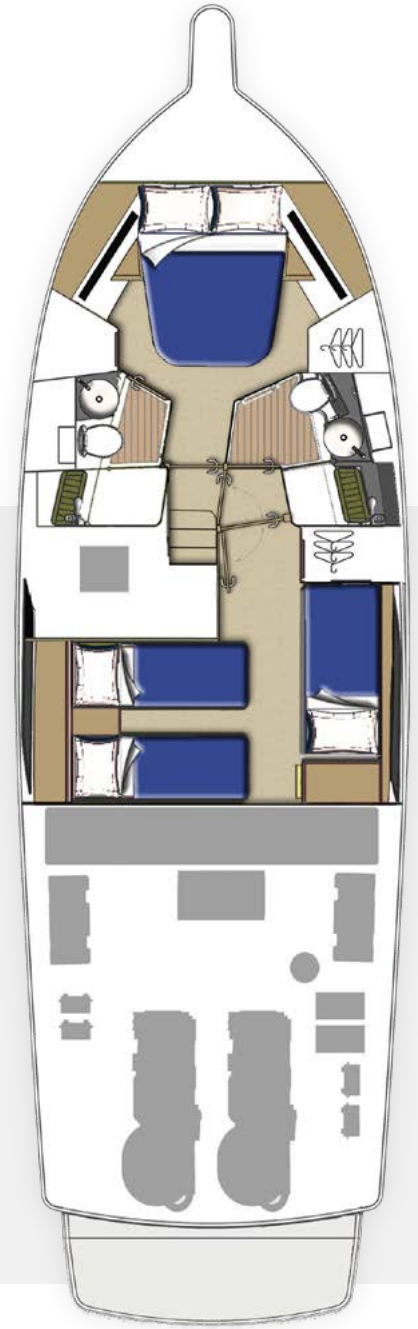

ACCOMMODATION DECK

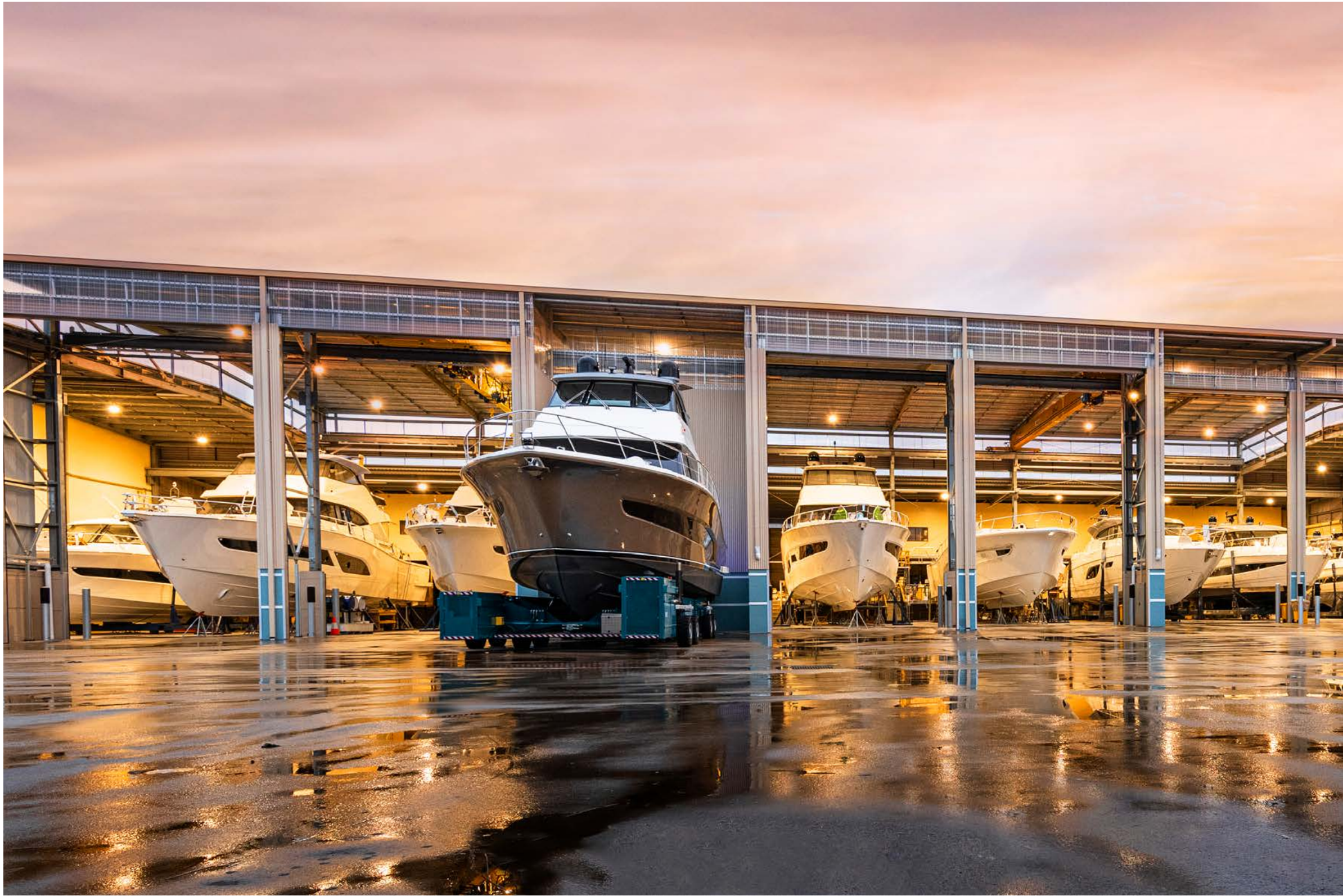



RIVIERA TODAY

Welcome to the largest luxury yacht-building facility in the Southern Hemisphere, our purpose-built, state-of-the-art 16.8 hectare site at Coomera, Gold Coast, Australia. Our proud heritage is a significant point of difference with the experience gained over 42 years launching almost 6,000 luxury motor yachts. Handcrafting yachts internationally-praised for their peerless quality, materials, structural strength, ease of operation and fine luxury finish.

Safety at sea is paramount and today's Riviera yachts are renowned for their blue water capability. So too is the passion for excellence shared by our award-winning Riviera team, maintaining a tradition of enduring quality that means your Riviera retains its value.

Today, Riviera builds the most advanced boats ever, exporting around 55% of our annual production to a global dealer network spanning every continent. We design and build luxury motor yachts from 39 to 78 feet in length across six distinct model collections. Owners can choose from the proven blue water Flybridge range, stylish and sophisticated Sport Yachts, the sporty and adventurous SUV series, long-range Sports Motor Yacht designs, the luxurious new Motor Yacht or the classic Belize Motor Yachts. New models designed to inspire our owners' boating lives. It's all part of a deep-seated culture of customer care which goes beyond after-sales support and maintenance. When you acquire a Riviera, you join a family of fellow owners worldwide sharing adventures and advancing their boating knowledge and experiences in harmony with us.



RivieraAustralia.com